

DTPM[®]

DTPM-MTM Collection Device (Molecular Transport Medium)

— User Guide —

REF PV990001

Version 1.0

DTPM, Inc.
913 Airport Road
Fort Payne, AL 35968

For Research Use Only
Not For Use In Diagnostic Procedures

Table of Contents

Specifications	3
Structure & Composition.....	3
Application	3
Application Method	4
Warnings.....	4
Storage	4
Transport	4
Production Date and Expiry Date	5
Explanation of Graphics and Symbols Used for Label.....	5
Distributed by.....	5
Technical Support.....	5

DTPM-MTM COLLECTION DEVICE

Specifications

The DTPM-MTM Collection Device includes the following contents: Nylon Flocked Swab; Nylon Nasal Flocked Swab; and 3 mL Molecular Transport Medium (Inactivated Medium).

Configuration

- 1 Nylon Flocked Swab
- 1 Nylon Nasal Flocked Swab
- 1 Tube containing 3 mL Molecular Transport Medium (Inactivated Medium)

Structure and Composition

Materials and Components for DTPM-MTM Collection Device

Part Name	Materials and Components
Nylon Flocked Swab Nylon Flocked Nasal Swab	Tip: Nylon Flocked (Polyamide 66 - PA66) Shaft: ABS
Collection Tube	Polypropylene (PP)
Molecular Transport Medium (Inactivated Medium)	Urea, Sodium Acetate (Anhydrous), Tris, EDTA, SDS, Absolute Ethanol, Water

Application

Pre-filled container used for specimen collection, transport, and storage. It is not intended for use as part of an over-the-counter test sample collection system.

Application Method:

1. Open the outer blister package containing disposable nylon flocked swabs and collection tube.
2. Label Collection Tube with sample name and date of collection.
3. Open the blister package containing the nylon flocked swab. Do not touch the flocked sampling tip against any surface.
4. Collect sample using a nylon flocked swab.
5. Open the collection tube and insert the flocked tip into the molecular transport medium.
6. Apply pressure to the shaft at the marked breakpoint against the side of the tube to separate the tip of the swab from the shaft.
7. Ensure the flocked tip is fully immersed in the molecular transport medium. Then, replace and tighten the cap of the tube to seal the collection tube.

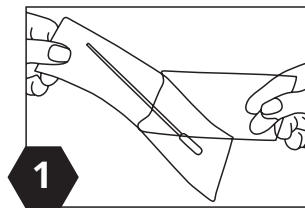

Open the package and remove the swab.

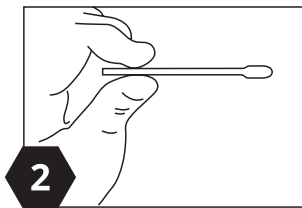

Collect the sample. Do not let the swab head touch anything else.

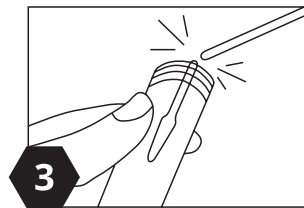

Place the swab head in the tube, breaking at the line provided.

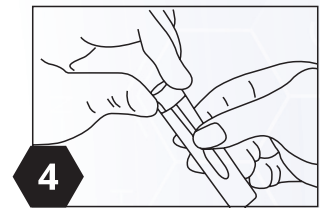

Tightly seal the tube with the lid.

Warnings:

1. Single Use Only, do NOT reuse swabs or molecular transport medium.
2. Handle all samples as potentially infectious substances.
3. ALWAYS wear appropriate Personal Protective Equipment (PPE) when handling the collection device or samples.
4. Personnel using the collection device must read these instructions carefully before use.
5. Waste generated during use must be treated as an infectious substance.
6. Do not eat or drink during sample collection.
7. Avoid contact with the molecular transport medium. If molecular transport medium contacts skin, rinse it off immediately with plenty of water.

Storage:

Store in a dry, ventilated, non-corrosive atmosphere at room temperature (15-30°C).









Transport:

Protect from heavy pressure, direct sunlight, and moisture.

Production Date and Expiry Date:

See product packaging for expiration.

Explanation of Graphics and Symbols Used for Label:

Symbol	Title of Symbol	Symbol	Title of Symbol
	Sterilization using Irradiation		Consult instructions for use
	CE marking of conformity		Single Use
	Temperature limit		Do not use if package is damaged
	Do not get wet		Catalogue number

Distributed by

DTPM, Inc.

913 Airport Road West, Fort Payne, Alabama, 35968

Technical Support

Contact DTPM Technical Support for any questions regarding use or for assistance with troubleshooting.

You may reach Technical Support using the following contacts:

Email: HELP@DTPM.com

Phone: (256) 845-1261